

# DuraFit End Stop



## PRODUCT DESCRIPTION

Provides a gas and water-tight seal of a MicroDuct pathway to prevent moisture or debris from entering the duct. An optional cover provides increased impact resistance. Metal-free end stops are available upon request.

## APPLICATION AREA

For use with MicroDucts in direct-buried or sub-duct applications.

## MAIN CHARACTERISTICS

### Material

**Body:** Clear Polyamide (PA)

**Grip:** Stainless Steel

**Cover:** Polypropylene (PP)

**Clips:** Polypropylene (PP)

### Temperature

**Installation:** -15 °C to +45 °C

**Transport and storage:** -15 °C to +45 °C

**Operation:** -15 °C to +45 °C

### Pressure

**Installation:** 15 bar

**Operation:** 25 bar

### Others

**UV Resistant:** No

Operational lifetime: 25+ years

**Impact resistance:** 1 joule (5 joules with cover)

### Standards

**General:** EN50411-2-8

**Lifetime:** 1,000-hour ageing at 95 °C

## TECHNICAL SPECIFICATIONS

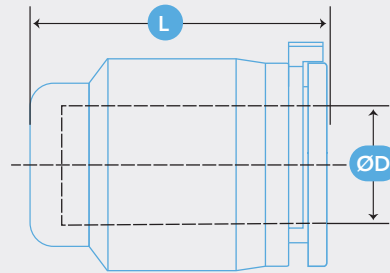

Size	ØD (mm)	ØE (mm)	L (mm)
4 mm	4.0	11.0	17.0
5 mm	5.0	13.0	17.3
7 mm	7.0	14.6	20.8
8 mm	8.0	14.6	20.8
10 mm	10.0	19.0	25.1
12 mm	12.0	21.5	25.6
14 mm	14.0	23.0	25.7
16 mm	16.0	26.0	27.0
18 mm	18.0	29.0	30.2
20 mm	20.0	31.0	30.7

## TECHNICAL DATA SHEET: ACCESSORIES

### PRODUCT VARIATIONS

Material Description	Length (mm)	Weight (g)	Pull out force (N)	SAP code
DuraEnd Stop 4mm with clips	17	3	80	20040006
DuraEnd Stop 5 mm with clips	17.3	3	110	20020024
DuraEnd Stop 7 mm with clips	20.8	4	190	20020006
DuraEnd Stop 8 mm with clips	20.8	4	320	20030016
DuraEnd Stop 10 mm with clips	25.1	8	340	20020005
DuraEnd Stop 12 mm with clips	25.6	9	390	20020015
DuraEnd Stop 14 mm with clips	25.7	10	390	20020035
DuraEnd Stop 16 mm with clips	27	19	586	20020057
DuraEnd Stop 18 mm with clips	30.2	19.5	700	20073131
DuraEnd Stop 20 mm with clips	30.7	20.3	1,200	20020227
DuraEnd Stop 7 mm with cover	41.3	8	200	20020006 20073069
DuraEnd Stop 8 mm with cover	41.3	8	300	20030016 20073069
DuraEnd Stop 10 mm with cover	41.7	12	350	20020005 20073070
DuraEnd Stop 12 mm with cover	51.5	13	475	20020015 20073071
DuraEnd Stop 14 mm with cover	51.3	14	600	20020035 20073072
DuraEnd Stop 16 mm with cover	51.3	19	584	20020057 20073076
DuraEnd Stop 18 mm with cover	55	25	700	20073131
DuraEnd Stop 20 mm with cover	60.6	32	1,200	20020227