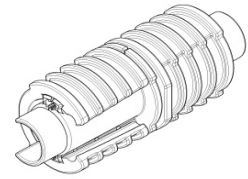

Technical datasheet for:

EBM

General data

Item	Divisible connector
Description	The tensile and divisible connector EBM ensures the permanent gas- and water-tight connection of occupied speedpipe up to 0.5 bar and for a duration of 30 minutes even up to 10 bar. Installation is carried out without any special tools.
Package unit	12 Pcs.

Technical data

Quality	Value	Unit
Material	PolyPhenylenOxid PPO	
Dimension	EBM 7:	d = 27; L = 88
	EBM 10:	d = 28; L = 88
	EBM 12:	d = 30; L = 88
	EBM 14:	d = 33; L = 88
	EBM 16:	d = 36; L = 92
Pressure	0.5 (permanent gas- and watertight)	
	10 / 30	bar / min
Tensile strength	EBM 7:	min. 70
	EBM 10:	min. 100
	EBM 12:	min. 120
	EBM 14:	min. 140
	EBM 16:	min. 160
Loading capacity of connecting clamps	min. 750	N
Fire behavior of case half and clamp (DIN EN 13501-1)	E - d2	

gabocom is certified by the quality system following DIN EN ISO 9001, the environmental management system DIN EN ISO 14001 and the energy management system DIN EN 50001. The used materials meet the REACH default (EU regulation 1907/2006) and the RoHS default (EU guidelines 2011/65).

gabo Systemtechnik GmbH
 Am Schaidweg 7
 94559 Niederwinkling
 GERMANY

Tel. +49 9962 950-200
 Fax +49 9962 950-202
 info@gabocom.com
 www.gabocom.com

Editor: LF
 Release: MK
 Date: 08.09.2016
 Edition: 3

No responsibility is taken for the currency and completeness of details and information. This document can be revised and supplemented without prior notice. Liability for damages is excluded.