

Charger 1000W

Appendix

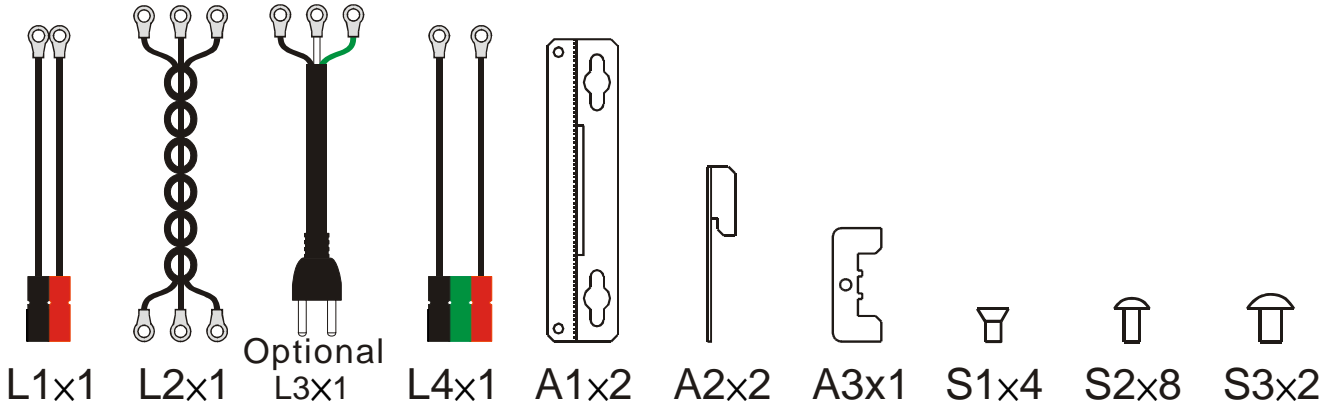

CAUTION: Input and output end wiring of charger please really lock on endson, avoid equipment got burned by contact impendence.

Placement of the Unit

①

Mount on Rear Panel of MSII6K

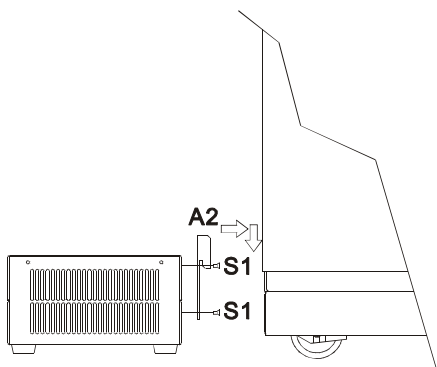

CAUTION:
It is forbidden to stack another unit on it in the situation.

②

Stack

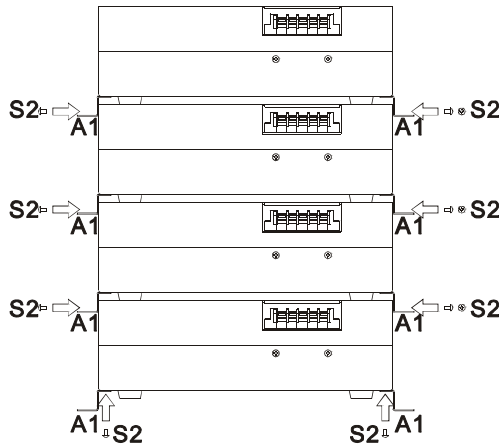

③

Wall Mount

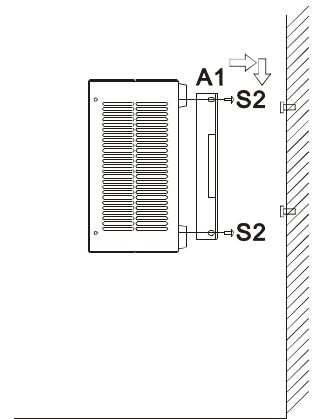

Set up

1 Tower: Connect Utility and DC Plug

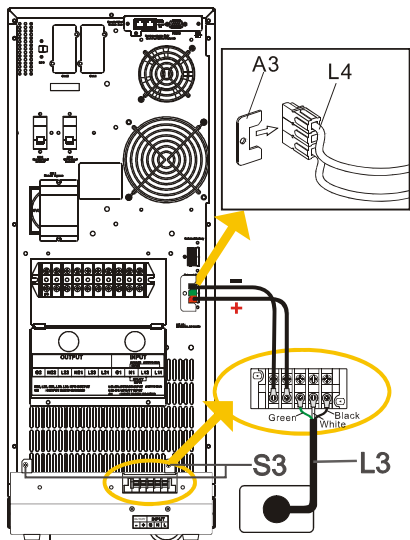

2 RT: Connect Utility and DC Plug

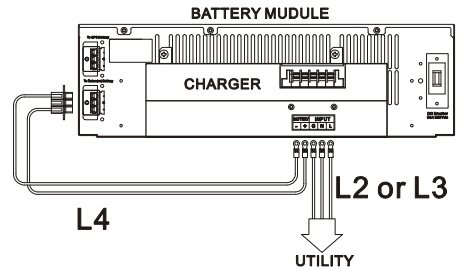
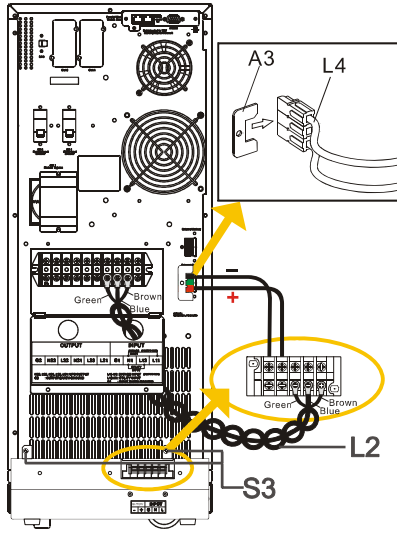

Parallel Connection

◎Number of parallel unit is up to 4.

- When connect 2 groups of Charger 1000W in parallel , please select UL 1015 16AWG line material or the equal line material for the charger line in parallel of input and output
- When connect 3 or 4 groups of Charger 1000W in parallel , please select UL 1015 14AWG line material or the equal line material for the charger line in parallel of input and output

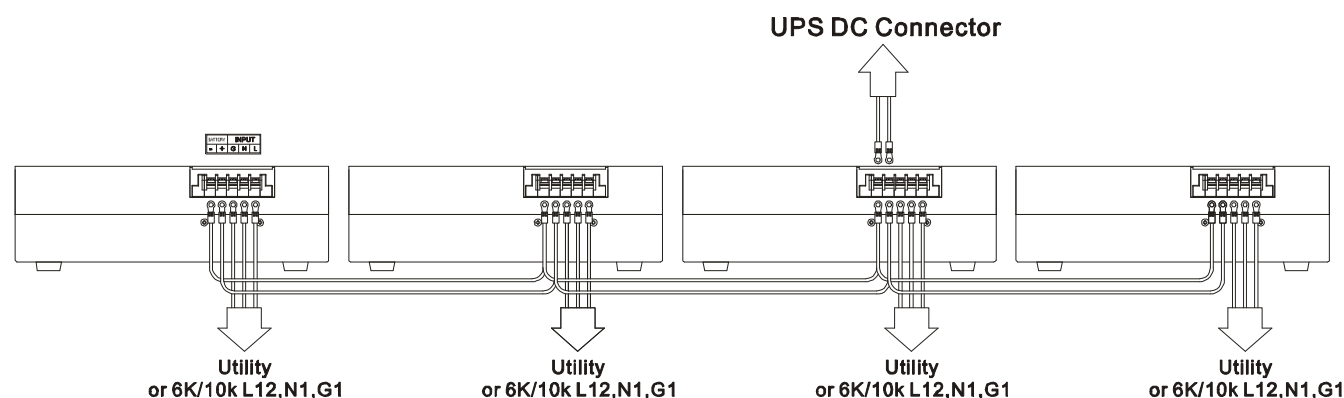

Specifications

AC INPUT	
Input Voltage	160V-280V
Current	4.6Arms Max.
Freq.	50Hz/60Hz±10%
Power Factor	> 0.85
DC OUTPUT	
Output Voltage	273Vdc ± 3Vdc (NO LOAD)
DC Output Current	5.0A Max.
Power Capacity	1000W Max.
Efficiency	> 0.85 at full load
Power Up Time	< 75ms
Line Regulation	≤ 1%(No LOAD)
Ripple	Approximate ±5V
Noise	Approximate ±3V
ENVIRONMENTAL	
Operation Temperature	0°C ~ 40°C
Cooling	Forced air ventilation by DC fan.
Humidity	10% ~ 90% RH
PHYSICAL	
Dimensions (WxLxH)mm	166.0 x 282.0 x 86.0
Net Weight (Kgs)	3.2

PS : Most greatly may parallel to 4000W (the maximum input current: 18.4A , maximum charging current: 20.0A)